

IT IS GLAZING VISION'S POLICY TO CONTINUOUSLY DEVELOP AND IMPROVE OUR PRODUCTS. WE THEREFORE RESERVE THE RIGHT TO MODIFY OR CHANGE THE DETAIL DESIGN AT OUR DISCRETION AND WITHOUT PRIOR NOTICE.

THIS DRAWING IS COPYRIGHT AND THE SOLE PROPERTY OF GLAZING VISION INC. THE DESIGNS / INFORMATION IT CONTAINS ARE PRIVATE AND CONFIDENTIAL. IT MUST NOT BE COPIED, EXHIBITED OR COMMUNICATED TO THIRD PARTIES FOR ANY PURPOSE OTHER THAN THAT FOR WHICH IT WAS ISSUED WITHOUT THE WRITTEN PERMISSION OF GLAZING VISION INC.

ALL DIMENSIONS IN INCHES UNLESS OTHERWISE STATED

CURB TO BE CONSTRUCTED TO WITHIN $\pm 1/4"$ ON STRAIGHT & $\pm 1/2"$ ON DIAGONAL DESIGNED SIZES. WEATHERING BY OTHERS.

ALL PRODUCTS MANUFACTURED TO 1/8" BY COMPONENT. OVERALL TOLERANCE NO MORE THAN 1/1000 OF TOTAL SIZE TO THE NEXT 1/8".

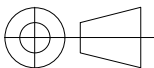

Third angle projection unless otherwise stated

THIS IS A STANDARD DRAWING, THE UNIT PURCHASED MAY VARY. THIS DRAWING DOES NOT INDICATE ACCURATE DIMENSIONS FOR ANY EXISTING STRUCTURAL COMPONENTS OR PRODUCTS.

DO NOT USE THIS DRAWING FOR ANY SITE LAYOUTS. ON-SITE PERSONNEL ARE RESPONSIBLE TO CONFIRM DRAWINGS VS SPECIFIC SITE CONDITIONS.

ESTIMATED WEIGHT N/A		SCALE Not to scale <small>(UNLESS OTHERWISE STATED)</small>
-------------------------	--	---

REVISION	DESCRIPTION	NAME/DATE
-	Initial Release	JSL 23/Jun/2020

PROJECT Flushglaze Fixed Skylight	
TITLE / DESCRIPTION Wall Abutment Requirements	CHECKED
DRAWING NO. 402-SDD-US-014	SHEET 1 OF 1

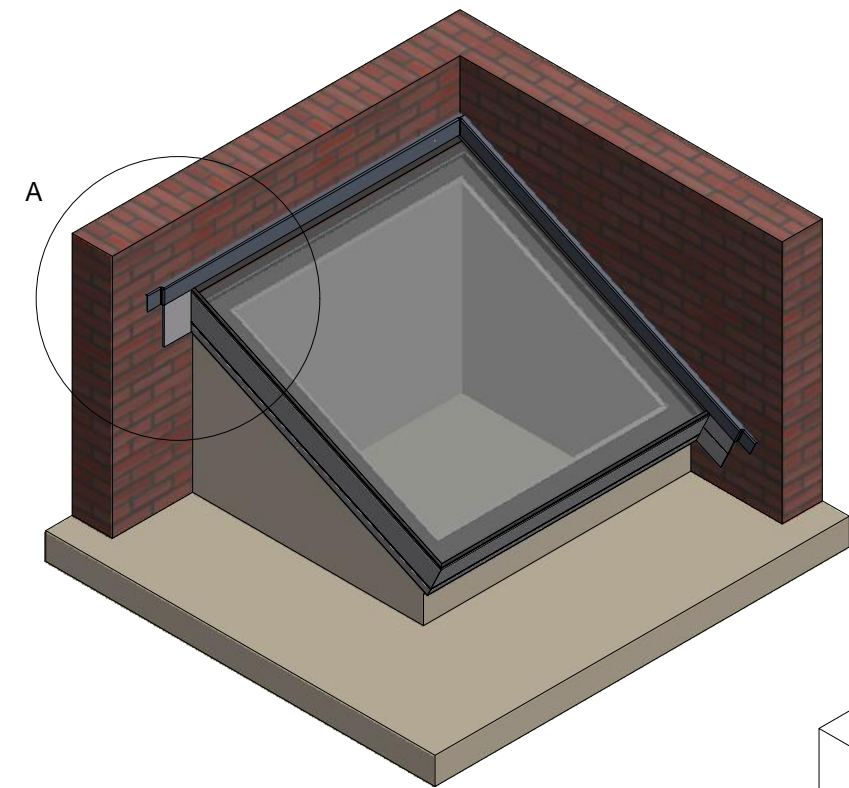

Detail A
Post Installation Weathering

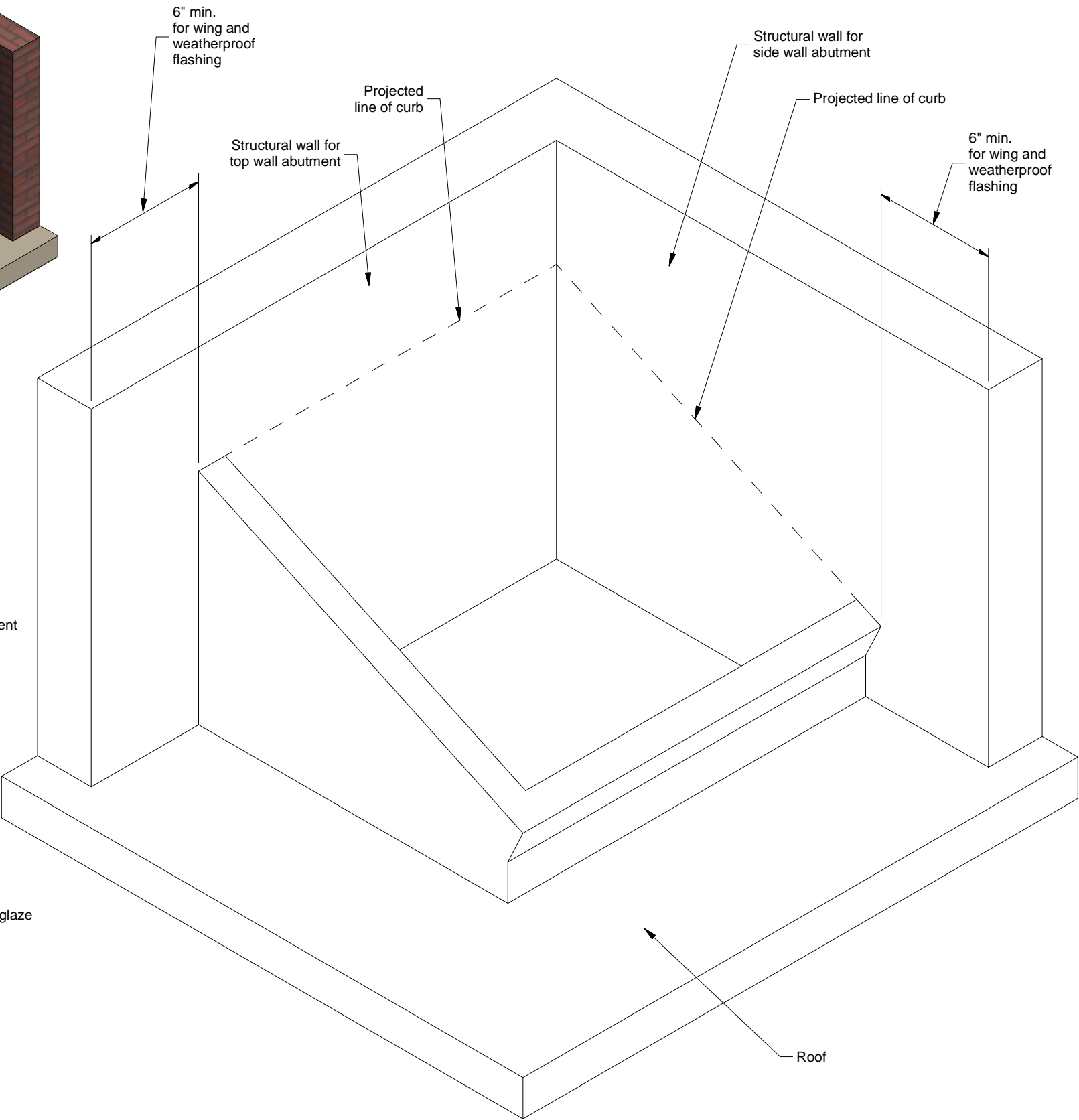
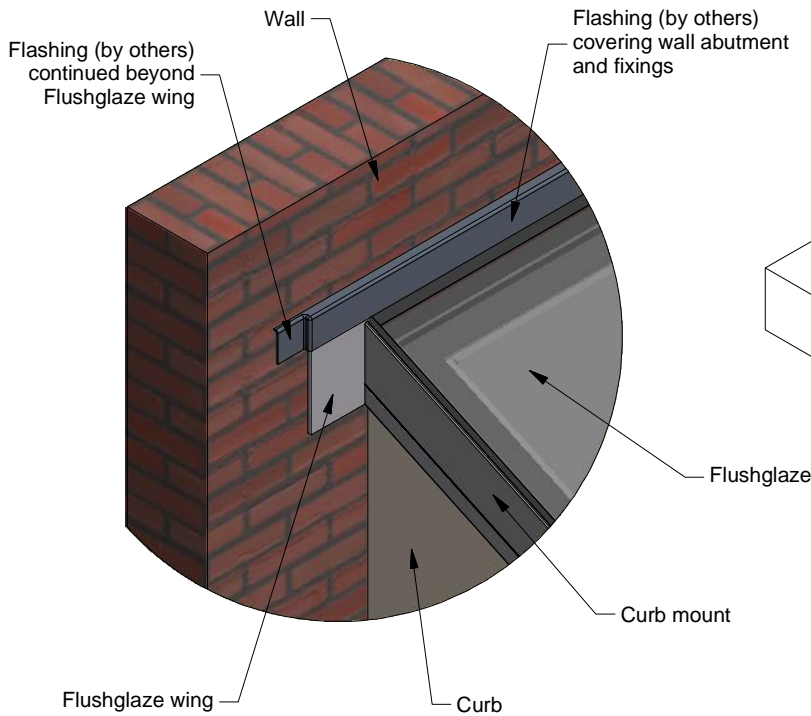

Refer to 100-SDD-US-001 for detailed curb information