

Section through glass corner join

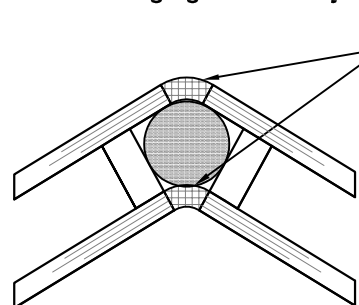

Factory applied low modulus neutral cure silicone (standard = Matt black) with polyethylene expanded foam backing rod

Section A-A  
With standard downlighter

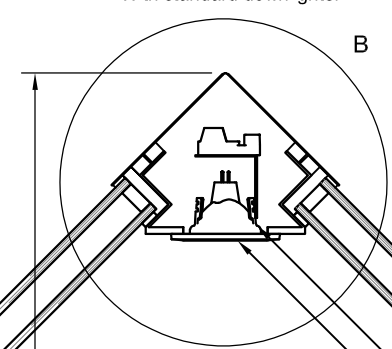

Detail B  
Downlighter removed

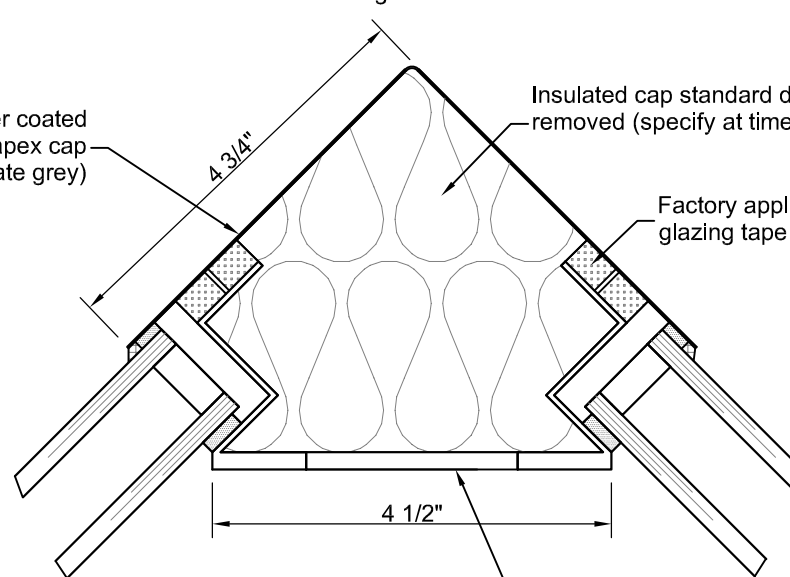

Polyester powder coated external aluminum apex cap (standard = RAL7015 Slate grey)

Insulated cap standard downlighter removed (specify at time of order)

Factory applied structural glazing tape

4 1/2"

Polyester powder coated internal apex (standard = RAL9005 Jet black)

Factory applied low voltage downlighter

Downlighter chrome bezel as standard

Insulated glass unit\*

C

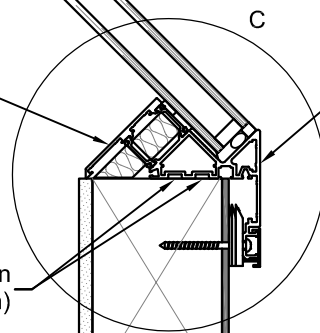

Polyester powder coated internal aluminum framework (standard = RAL9010 Pure white)

Polyester powder coated external aluminum framework (standard = RAL7015 Slate grey)

Silicone seal applied during installation (supplied by Glazing Vision)

12" : 12" Pitch  
(45.0°)

Factory applied PIR insulation

Powder coated aluminum clip on cover to hide structural curb fixing No.12 x 2 1/2" Stainless steel woodscrew with packers (supplied by Glazing Vision)

7/8"

Internal opening dependent on curb thickness and internal finishes

Curb Span

Critical dimension. Includes all weathering finishes (Customer to specify)

\*Varies dependent on glass specification

Double glazed unit with tempered inner shown, but other options are also available.

Check your quote/order confirmation for specific information on what's been specified in your product.

Detail C = 404-SDD-US-008

\*\*Height ≈ (SPAN/2) + 2 1/2"

**GLAZING VISION**  
the glass skylight company

☎: 833-SKYDOOR (833-759-3667)

🌐: www.glazingvision.com

✉: sales@glazingvision.com

IT IS GLAZING VISION'S POLICY TO CONTINUOUSLY DEVELOP AND IMPROVE OUR PRODUCTS. WE THEREFORE RESERVE THE RIGHT TO MODIFY OR CHANGE THE DETAIL DESIGN AT OUR DISCRETION AND WITHOUT PRIOR NOTICE.

THIS DRAWING IS COPYRIGHT AND THE SOLE PROPERTY OF GLAZING VISION INC. THE DESIGNS / INFORMATION IT CONTAINS ARE PRIVATE AND CONFIDENTIAL. IT MUST NOT BE COPIED, EXHIBITED OR COMMUNICATED TO THIRD PARTIES FOR ANY PURPOSE OTHER THAN THAT FOR WHICH IT WAS ISSUED WITHOUT THE WRITTEN PERMISSION OF GLAZING VISION INC.

ALL DIMENSIONS IN **INCHES** UNLESS OTHERWISE STATED

CURB TO BE CONSTRUCTED TO WITHIN  $\pm 3/8"$  ON STRAIGHT &  $\pm 1/2"$  ON DIAGONAL DESIGNED SIZES. WEATHERING BY OTHERS.

ALL PRODUCTS MANUFACTURED TO 1/8" BY COMPONENT. OVERALL TOLERANCE NO MORE THAN 1/1000 OF TOTAL SIZE TO THE NEXT 1/8"

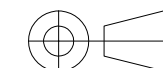

Third angle projection unless otherwise stated

THIS IS A STANDARD DRAWING, THE UNIT PURCHASED MAY VARY. THIS DRAWING DOES NOT INDICATE ACCURATE DIMENSIONS FOR ANY EXISTING STRUCTURAL COMPONENTS OR PRODUCTS.

DO NOT USE THIS DRAWING FOR ANY SITE LAYOUTS. ON-SITE PERSONNEL ARE RESPONSIBLE TO CONFIRM DRAWINGS VS SPECIFIC SITE CONDITIONS.

ESTIMATED WEIGHT	N/A	SCALE	Not to scale
		(UNLESS OTHERWISE STATED)	

REVISION	DESCRIPTION	NAME/DATE
-	Initial Release	JSL 11/Nov/2020

PROJECT Pyramid and Lantern	
TITLE / DESCRIPTION Square Pyramid Section	CHECKED AB
DRAWING NO. 404-SDD-US-005	SHEET 1 OF 1